

# State of Wyoming Corner Record

(In compliance with the CORNER PERPETUATION AND FILING ACT, Wyoming Statutes, 1977, Section 36-11-101, et. seq., and the Rules and Regulations of the Board of Registration for Professional Engineers and Professional Land Surveyors.)

Reverse side of this form may be used if more space is needed.

Record of original survey and citation of source of historical information (if corner is lost or obliterated). Description of corner monumentation evidence found and/or monument and accessories established to perpetuate the location of this corner. Sketch of relative location of monument, accessories, and reference points with course and distance to adjacent corner(s) (if determined in this survey). Method and rationale for reestablishment of lost or obliterated corner.

G.L.O. Record: Unknown

Supplemental Record: Certified Land Corner Recordation Certificate filed on Feb. 17, 1988 by Mr. Larry T. Perry, Wyoming L.S. 3047, indicating a found stone.

Found: 14"x6"x 6" Granite stone, well marked, firmly set 11" in the ground, with three horizontal grooves on the South edge and 4 horizontal grooves on the East edge.

Set: 2 1/2" x 30" Galvanized Iron Pipe, 26" in the ground with a 3 1/4" Brass Cap marked as noted below. Buried the original stone as a memorial south of the remonumented corner point. Set the L.T. Perry 6' blue fence post 1' north and 3 feet in the ground as a witness.

Brass Cap Markings

T.14N.R.67W.

17	16
20	21

1995  
P.L.S. 2927

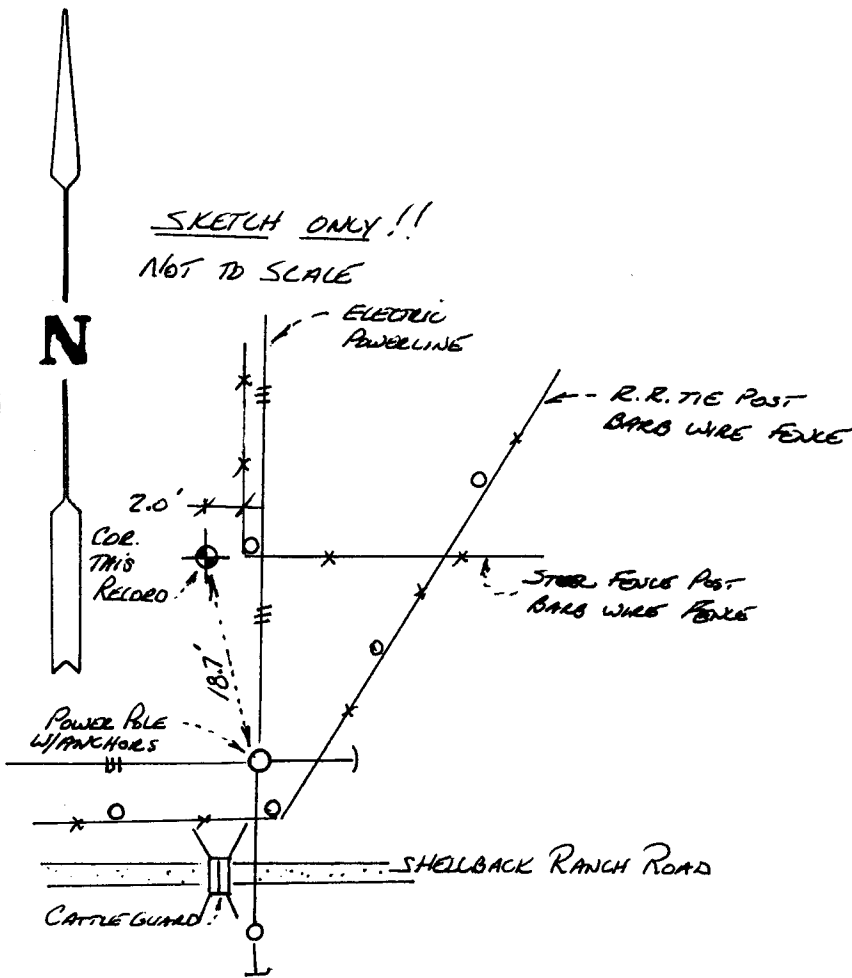

LARAMIE COUNTY CLERK  
 CHEYENNE, WY.  
 '95 OCT 26 PM 1 09

171149

Date of Field Work: 10-24-95 Office Reference: A.V.I., Job No. 2-1933.95

### CROSS INDEX DIAGRAM

A	1	2	3	4	5	6	7	8	9	10	11	12	13	14	15	16	17	18	19	20	21	22	23	24	25
B																									
C	6				5					4					3					2				1	
D																									
E																									
F																									
G	7				8					9					10					11				12	
H																									
I																									
J																									
K																									
L	18				17					16					15					14				13	
M																									
N																									
O																									
P	19				20					21					22					23				24	
Q																									
R																									
S																									
T	30				29					28					27					26				25	
U																									
V																									
W																									
X	31				32					33					34					35				36	
Y																									
Z																									

Firm/Agency, Address

PREPARED BY:

Paul A. Reid, P.L.S.  
A.V.I., P.C.  
2035 Westland Road  
Cheyenne, WY 82001

(307) 637-6017

This corner record was prepared by me or under my direction and supervision.

SEAL & SIGNATURE

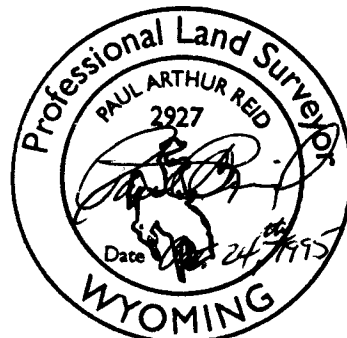

V. 1467

BOOK 1409